

Courses and distances commencing at the South end of Kings Bridge, at a Stone, thence up French Creek

1 st	East	8	perches
2 ^d	N 75	6	12 do
3	N 66	6	8 do
4	N 57	6	7
5	N 47	6	7
6	N 40	6	12
7	N 40	6	7
8	N 12	6	8
9	N 18	11	8
10	N 43	11	18
11	N 74	11	6
12	N 50	11	14
13	N 84	11	8
14	N 37	11	7
15	N 33	6	6
16	N 33	6	13
17	N 31	6	24
18	N 35	6	16
19	N 35	6	13
20	S 85	11	20
21	N 13	6	18
22	N 65	6	16
23	N 84	6	24 to
24	N 68	6	to
a White Walnut, Thence			
25	S 22 1/2	664	post
26	S 89 1/2	1125	stone
27	N	526	place of beginning

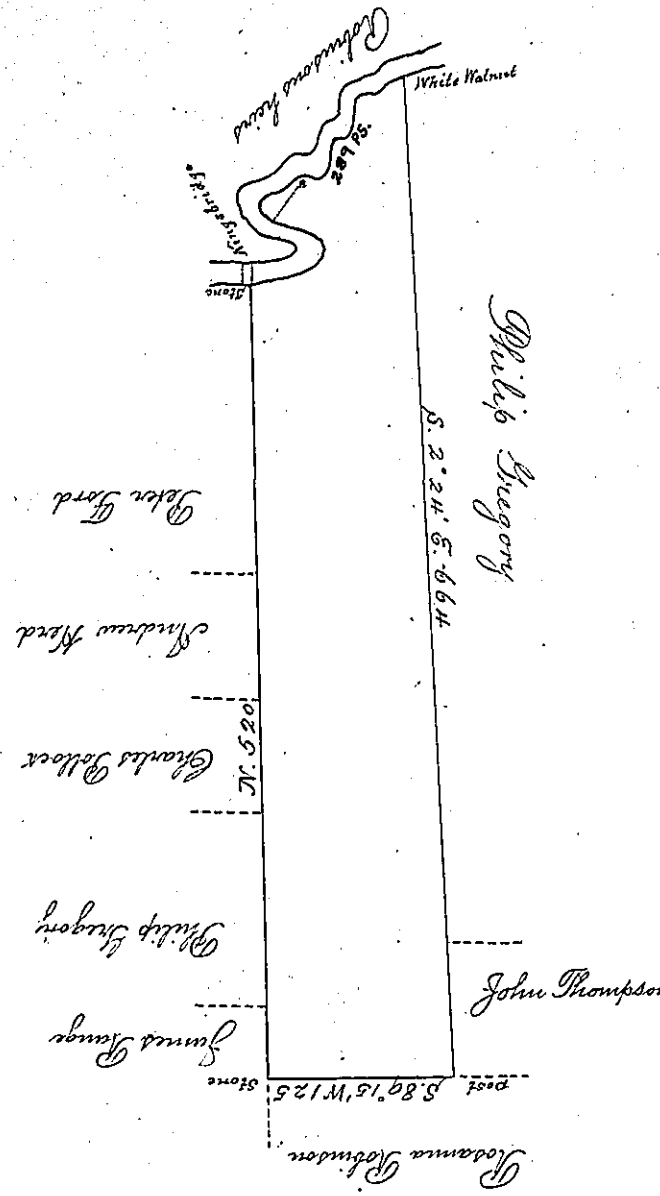

A draught of a tract of Land in Leboct Township, Erie County on French Creek. Resurveyed the 22^d day of Sept^r 1836 for Philip Gregory Archibald Black by virtue of Thomas Black's Warrant dated April 3^d 1802 the lines run in conformity to a decision at Law. Containing four hundred acres and six per cent allowance for roads &c.

I certify the above is a Return of a Survey made and entered in the Survey Book by me with the field notes annexed, and there is now no adverse claim to the above described premises

S. Skinner D.S.

To John Taylor Esq. S. G.

Nov. 23^d 1838

IN TESTIMONY that the above is a copy of the original remaining on file in the Department of Internal Affairs of Pennsylvania, made conformably to an Act of Assembly approved the 16th day of February, 1833, I have hereunto set my Hand and caused the Seal of said Department to be affixed at Harrisburg, this

third day of February 18303.

James W. Lewis
Secretary of Internal Affairs.